

防水盒系列

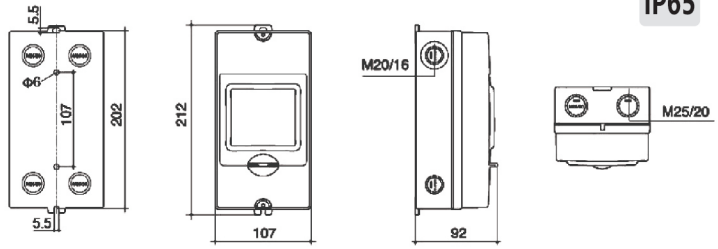

IP65 CE

LK107-4P



LK165-6P

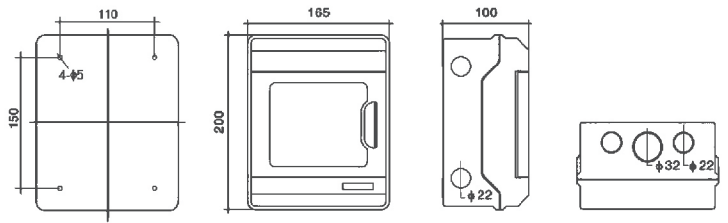

LK219-9P

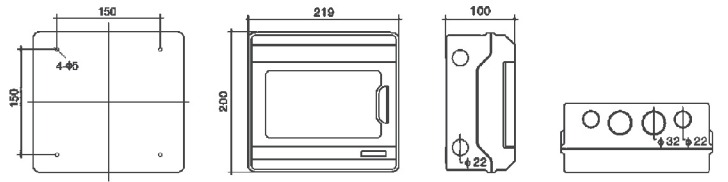

LK273-12P

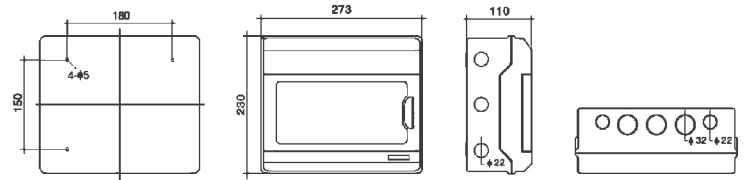

LK381-18P

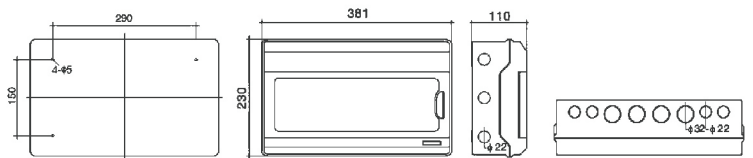

IP65 CE

LK273-24P

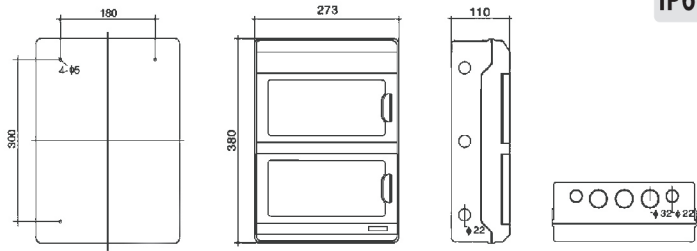

LK273-36P

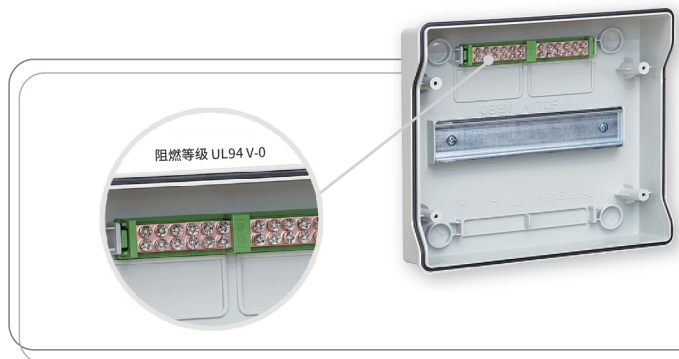
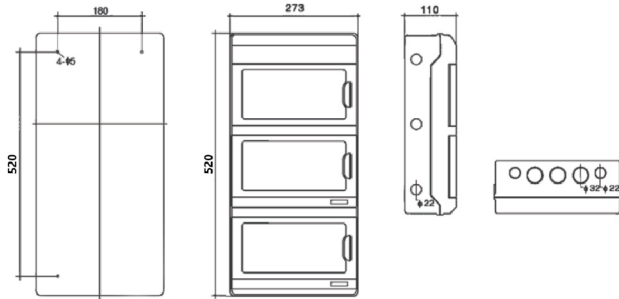

配电箱防尘盖板

盖板由聚碳酸酯制成

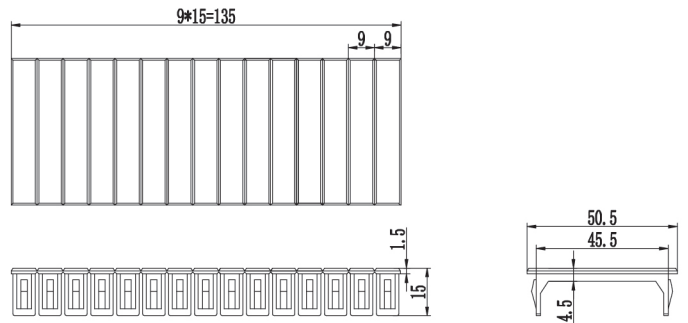

	产品代码	类型	重量(克)	包装(件)
LK15P	0D02-0030	关闭	12	100

IP65 CE

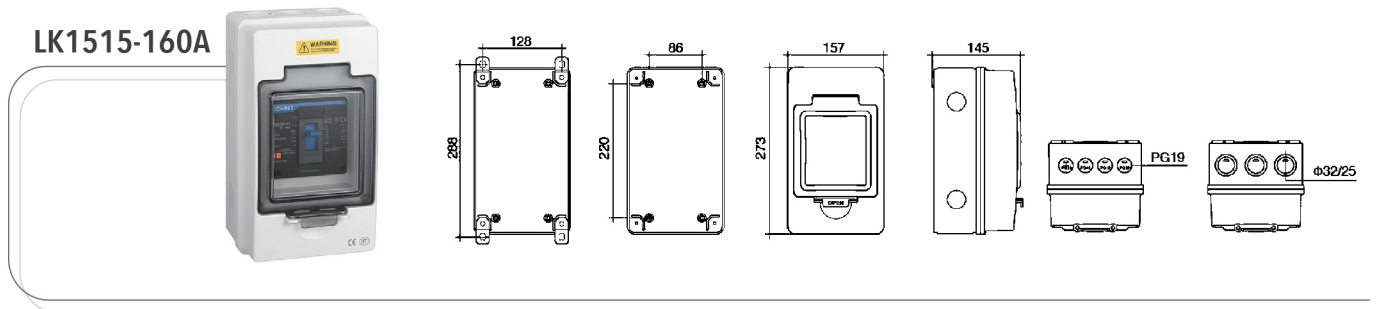
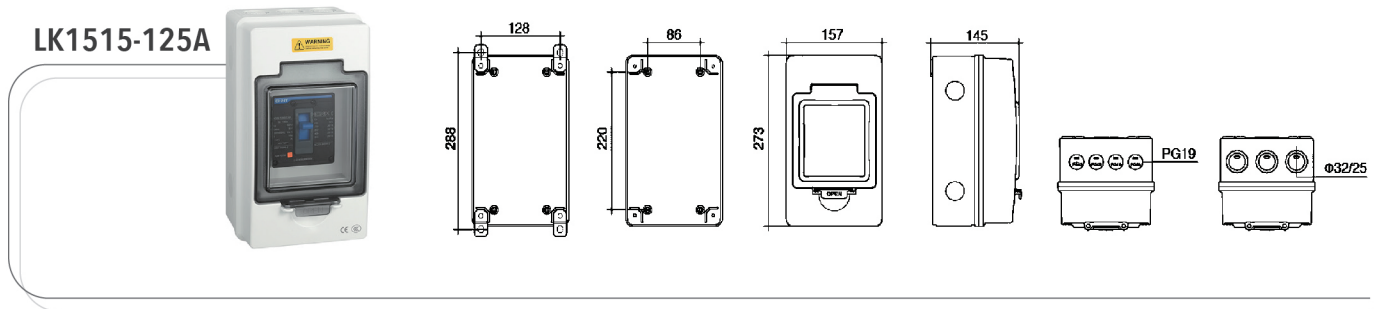
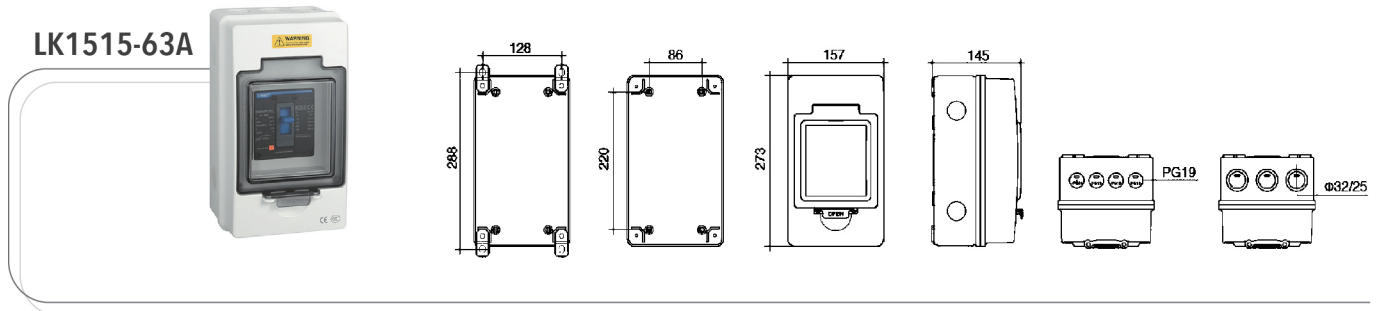
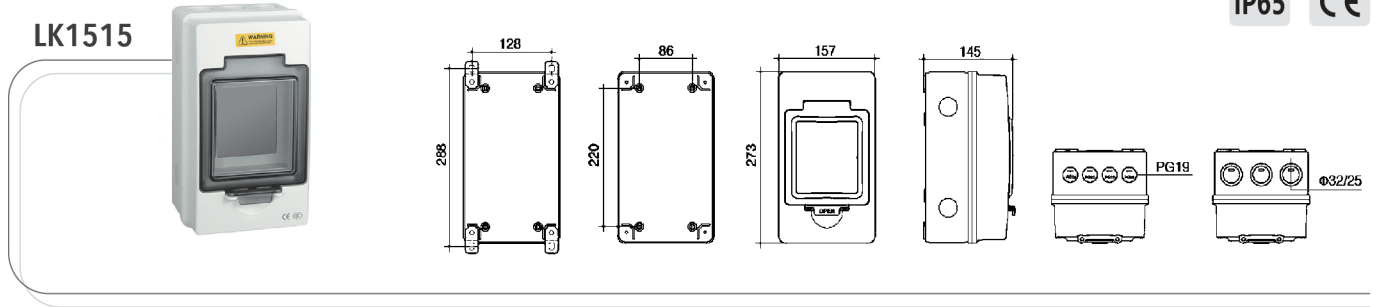

内部中性点和接地端子
Ø8欧式接线手柄



配件



LK 系列

防水配电箱 (IP65)

LK系列配电箱符合IEC-493-1标准, 美观耐用, 安全可靠, 广泛应用于工厂、大厦、住宅、购物中心等各种场所。

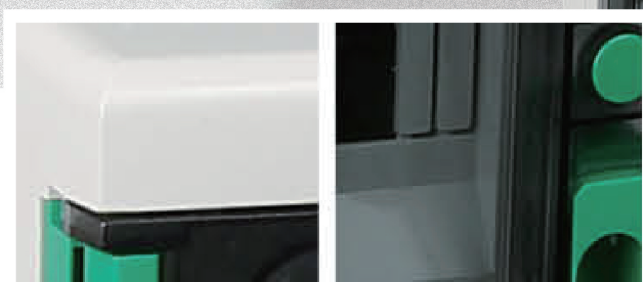

■ 面板采用工程ABS材质, 强度高, 永不变色, 透明部分采用PC材质。

■ 盖板按压式开合

配电箱面罩采用按压式开合方式, 轻按即可打开面罩, 开启时采用自锁定位铰链结构。

■ 配电箱走线设计

导轨支撑板可提升至最高活动点, 走线不再受限于狭窄空间。为方便安装, 配电箱开关处设有线槽和线管出线孔, 方便适应各种线槽和线管。

产品尺寸

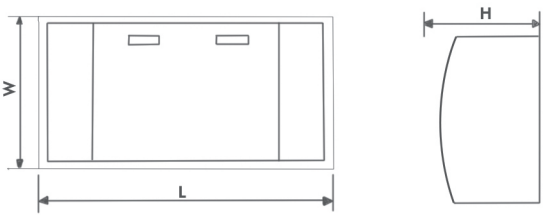
		尺寸		
		L (mm)	W (mm)	H (mm)
	LK-4P	143	210	100
	LK-8P	215	210	140
	LK-12P	298	260	140
	LK-18P	410	285	140
	LK-24P	298	420	140
	LK-36P	298	570	140

LK0012B

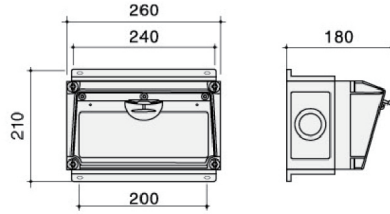

LK0024B

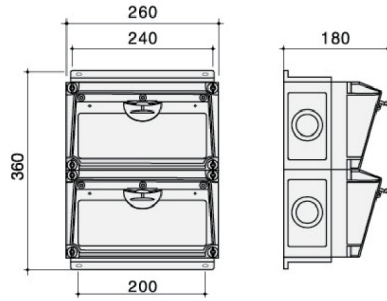

LK0036B

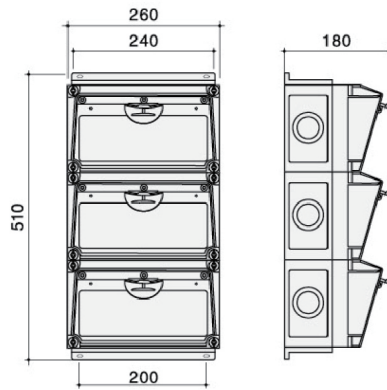

LK0048B

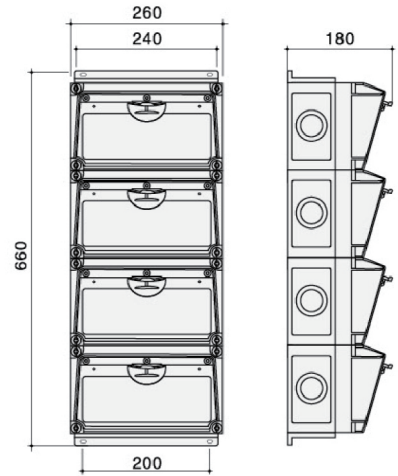

LK0012

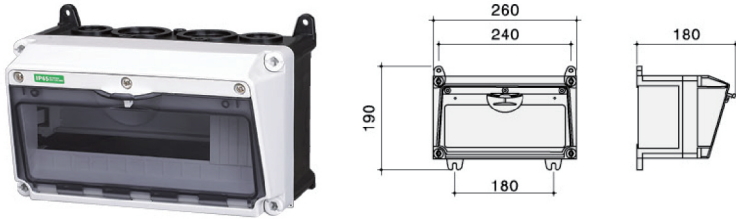

LK0024

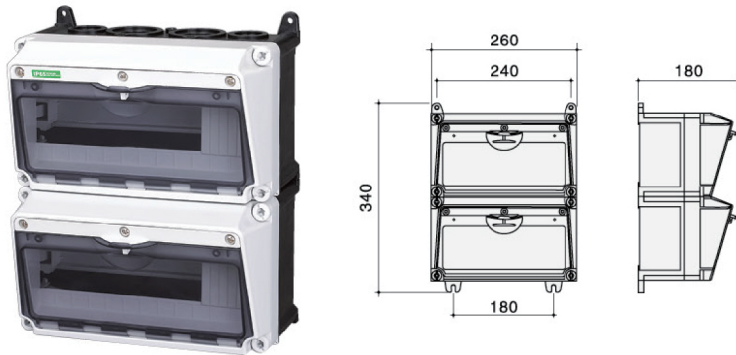

LK0036

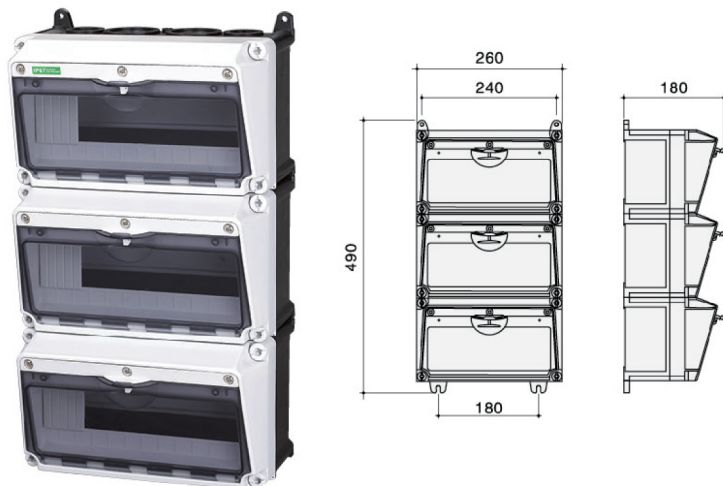

LK0048



LK 系列 不锈钢合页型电气箱

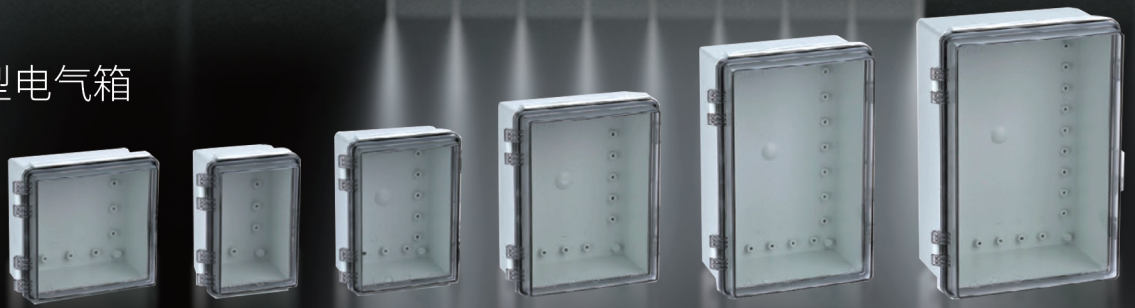

防水、防尘、耐腐蚀、高强度绝缘；

可根据用户需求随意开孔，规格齐全、安装方便；

执行标准：IEC60529、IP65、EN60309。

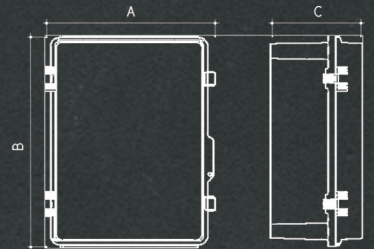

	外形尺寸				外形尺寸		
	A	B	C		A	B	C
LK101590	100	150	90	LK253515	250	350	150
LK121790	125	175	90	LK334318	330	430	180
LK151590	150	150	90	LK435320	430	530	20
LK162110	160	210	100	LK436323	430	630	230
LK172711	175	275	110	LK537325	530	730	250
LK203013	200	300	130	LK638328	630	830	280



IP65 CE

KPA9



KPA11



KPA12



KPA13



KPA16



KPA15



KPA14



	A	B	C	D	E	F	G	H	I	L	M	N	P	Q
KPA9	100	100	59	88	88	66	70.5	10	53	44	-	-	48	65
KPA11	115	140	61	128	103	107	66	10	55	46	-	-	90	81
KPA12	141	166	64	153	128	121	99	12.5	58	49	-	-	104	100
KPA13	168	192	80	176	152	153	113	10	74	65	-	-	128	125
KPA14	217	253	93	236	201	188	153	12.5	85	75	38	21	169	162
KPA15	264	314	122	292	243	238	198	12.5	114	106	49	24	203	192
KPA16	315	410	150	386	291	333	248	12.5	141	126	61	31	295	246

KPA9

KPA9 尺寸、安装孔和安装孔位置

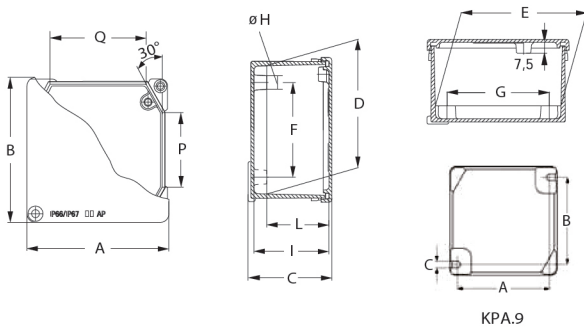

KPA11/12/13/14/15/16

KPA11/12/13/14/15/16 尺寸、安装孔及安装孔位置

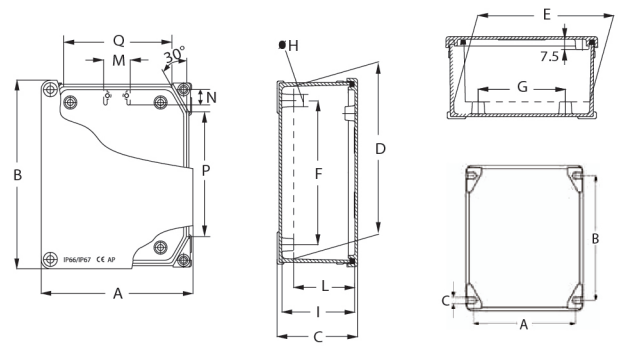



	订货号	L(MM)	W(MM)	D(MM)
LK080807	510.080807	80	80	65
LK140806	510.140806	140	80	60
LK161007	510.161007	160	100	70
LK161609	510.161609	160	160	90
LK221208	510.221208	220	120	80
LK261609	510.261609	260	160	90
LK271509	510.271509	270	150	90
LK282311	510.282311	280	230	110
LK332312	510.332312	330	230	120
LK402311	510.402311	400	230	110

尺寸图(mm)

LK080807产品尺寸及安装孔位置

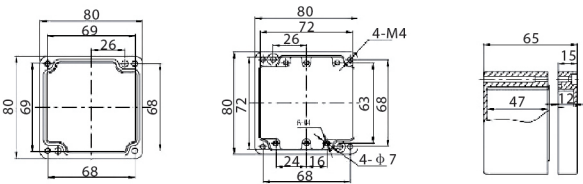

LK140806产品尺寸及安装孔位置

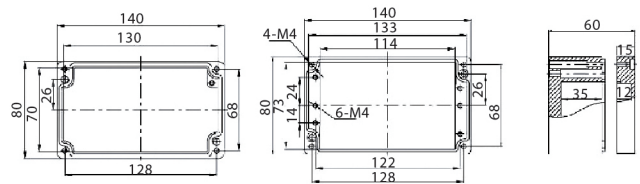

LK161007产品尺寸及安装孔位置

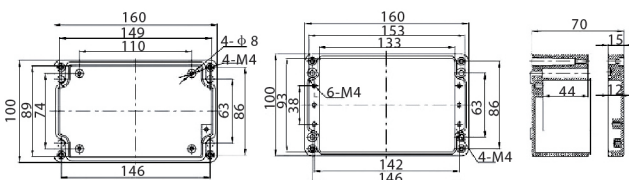

LK161609产品尺寸及安装孔位置

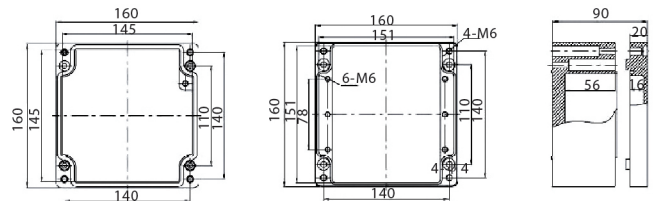

IP65 CE



	外形尺寸				外形尺寸		
	A	B	C		A	B	C
LK586435	58	64	35	LK152010	150	200	100
LK081170	80	110	70	LK152013	150	200	130
LK081370	80	130	70	LK152510	150	250	100
LK081870	80	180	70	LK152513	150	250	130
LK082570	80	250	70	LK202010	200	200	100
LK101075	100	100	75	LK202013	200	200	130
LK121275	125	125	75	LK192813	190	280	130
LK121775	125	175	75	LK282813	280	280	130
LK151575	150	150	75	LK283813	280	380	130

LK 欧洲系列防水电箱

IP65 CE

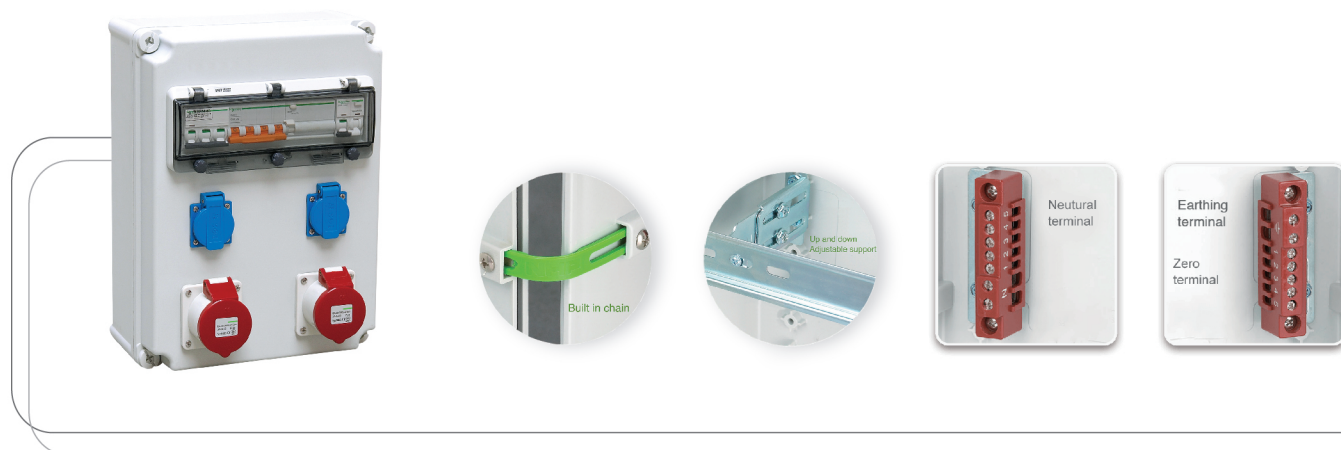

防水, 防尘, 防腐蚀, 强力安装。任何打开方式都可以按客户需求定制, 规格齐全, 安装便捷。
执行标准: IEC60529、IP65、EN60309

IP65 CE



LK223415



220x300x150mm

LK304016



300x400x160mm

LK305216



300x520x160mm

LK274616



270x460x160mm

LK365418



360x540x180mm

LK233316



230x330x160mm

LK282816



280x280x160mm

LK363616



360x360x160mm

LK608022



600x800x220mm



IP65 CE



尺寸图(mm)

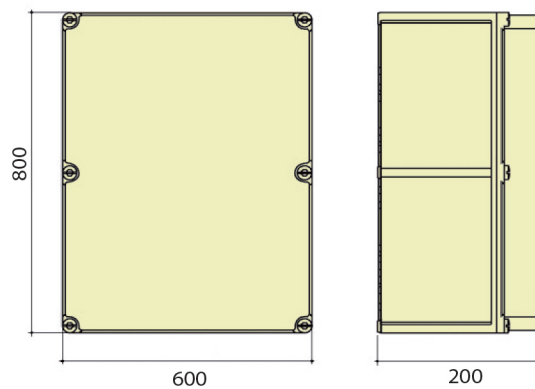

LK3020173



LK3020173-T



尺寸:300x200x170mm

LK4030173-T



LK4030173



尺寸:400x300x170mm

LK5040203



LK5040203-T



尺寸:500x400x200mm

LK6040223-T



LK6040223



尺寸:600x400x220mm



高级塑料防水盒

IP67 CE



产品特点

1. LK-AGS接线盒的连接螺栓采用注塑成型，在与接线盒连接时具有足够的强度，不易断裂。
 2. 四面滑动的设计，更有效地抵抗冲击。
- IP等级：IP67
冲击等级：IK08
温度范围：ABS-40~+70°C，聚碳酸酯(PC)：-40~+110°C
可燃性：ABS 94-HB；聚碳酸酯(PC)：94-V-0.5VA,HB

特征

- ABS 丙烯腈-丁二烯-苯乙烯 聚碳酸酯
- PC/ABS 丙烯腈-丁二烯-苯乙烯
- PC：聚碳酸酯
- 备注：透明/灰色

雕刻/印刷/定制开发服务

- 雕刻处理服务
通过积累精密孔加工技术经验，满足客户各种需求
- 丝网印刷及雕刻服务
精湛的丝网印刷及雕刻工艺，让您的产品更加出众
- 非标定制开发服务
根据客户要求，提供各种程序，为客户进行非标定制开发

LK-AGS系列命名方法及型号

IP67 CE

型号名称:
LK—UVW—XYZ 系列; [U=A.P.C; V=G.T; W=S; X=05-20; Y=06-20; W=05-13]

LK	-	A	G	S	-	50	65	55
----	---	---	---	---	---	----	----	----

材料: A-ABS
P-PC/ABS
C-PC

颜色: G 灰色
T 透明

类型: S型螺栓
P-SUS SUS锁紧型
H-SUS
SUS锁紧铰链型

[L] 铰链, 锁定安装表面

[H] 包容性

[W]

塑料	尺寸[mm]	ABS	ABS/PC	PC	PC
		灰色盖子	透明盖子	灰色盖子	透明盖子
--	50x65x55	LK-AGS-060505	LK-PTS-060505	LK-CGS-060505	LK-CTS-060505
--	65x95x55	LK-AGS-090605	LK-PTS-090605	LK-CGS-090605	LK-CTS-090605
LK-0811P	80x110x70	LK-AGS-110807	LK-PTS-110807	LK-CGS-110807	LK-CTS-110807
LK-0811P	80x110x85	LK-AGS-110808	LK-PTS-110808	LK-CGS-110808	LK-CTS-110808
LK-0813P	80x130x70	LK-AGS-130807	LK-PTS-130807	LK-CGS-130807	LK-CTS-130807
LK-0813P	80x130x85	LK-AGS-130808	LK-PTS-130808	LK-CGS-130808	LK-CTS-130808
LK-0818P	80x180x70	LK-AGS-180807	LK-PTS-180807	LK-CGS-180807	LK-CTS-180807
LK-0825P	80x250x70	LK-AGS-250807	LK-PTS-250807	LK-CGS-250807	LK-CTS-250807
LK-0825P	80x250x85	LK-AGS-250808	LK-PTS-250808	LK-CGS-250808	LK-CTS-250808
LK-1010P	100x100x75	LK-AGS-101007	LK-PTS-101007	LK-CGS-101007	LK-CTS-101007
LK-1212P	125x125x75	LK-AGS-121207	LK-PTS-121207	LK-CGS-121207	LK-CTS-121207
LK-1212P	125x125x100	LK-AGS-121210	LK-PTS-121210	LK-CGS-121210	LK-CTS-121210
LK-1217P	125x175x75	LK-AGS-171207	LK-PTS-171207	LK-CGS-171207	LK-CTS-171207
LK-1217P	125x175x100	LK-AGS-171210	LK-PTS-171210	LK-CGS-171210	LK-CTS-171210
LK-1417P	140x170x95	LK-AGS-171409	LK-PTS-171409	LK-CGS-171409	LK-CTS-171409
LK-1520P	150x200x100	LK-AGS-201510	LK-PTS-201510	LK-CGS-201510	LK-CTS-201510
LK-1520P	150x200x130	LK-AGS-201513	LK-PTS-201513	LK-CGS-201513	LK-CTS-201513
LK-1525P	150x250x100	LK-AGS-251510	LK-PTS-251510	LK-CGS-251510	LK-CTS-251510
LK-1525P	150x250x130	LK-AGS-251513	LK-PTS-251513	LK-CGS-251513	LK-CTS-251513
LK-1717P	175x175x100	LK-AGS-171710	LK-PTS-171710	LK-CGS-171710	LK-CTS-171710
LK-2020P	200x200x100	LK-AGS-202010	LK-PTS-202010	LK-CGS-202010	LK-CTS-202010
LK-2020P	200x200x130	LK-AGS-202013	LK-PTS-202013	LK-CGS-202013	LK-CTS-202013
LK-1928P	190x280x130	LK-AGS-192813	LK-PTS-192813	LK-CGS-192813	LK-CTS-192813

安装尺寸/适用附件

IP67 CE

尺寸图(mm)

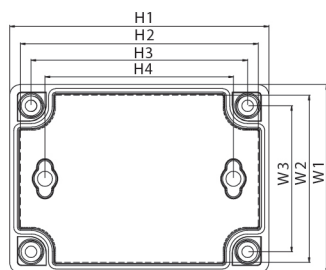

底座

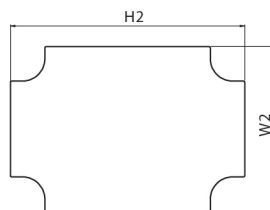
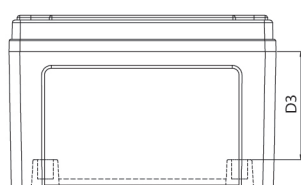
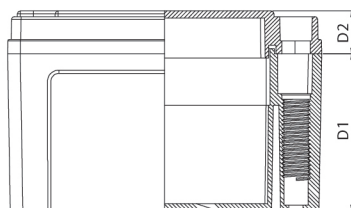

安装板

配件

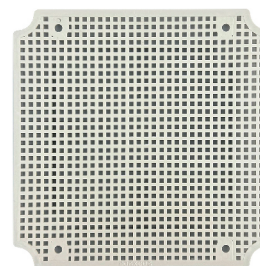

塑料板 [ABS]



4个

	W1	W2	W3	H1	H2	H3	H4	D1	D2	D3
50x65x55	50	43	38	65	58	53	39.8	35	20	25.5
65x95x55	65	58	47	95	88	77	0	40	15	35.5
80x110x70	80	73	62	110	103	92	80	55	15	44.5
80x110x85	80	73	62	110	103	92	80	55	30	44.5
80x130x70	80	73	62	130	123	112	100	55	15	44.5
80x130x85	80	73	62	130	123	112	100	55	30	44.5
80x180x70	80	73	62	180	175	162	150	55	15	44.5
80x250x70	80	73	62	250	243	232	220	55	15	44.5
80x250x85	80	73	62	250	243	232	220	55	30	44.5
100x100x75	100	93	82	100	93	82	60	60	15	49.5
125x125x75	125	118	107	125	118	107	70	60	15	49.5
125x125x100	125	118	107	125	118	107	70	60	40	49.5
125x175x75	125	118	107	175	168	157	140	60	15	49.5
125x175x100	125	118	107	175	168	157	140	60	40	49.5
140x170x95	140	132	122	170	162	152	130	80	15	69
150x200x100	150	142	132	200	192	182	160	85	15	74
150x200x130	150	142	132	200	192	182	160	85	45	74
150x250x100	150	142	132	250	242	232	210	85	15	74
150x250x130	150	142	132	250	242	232	210	85	45	74
175x175x100	175	167	157	175	167	157	140	85	15	74
200x200x100	200	192	182	200	192	182	159.5	85	15	74
200x200x130	200	192	182	200	192	182	159.5	85	45	74

IP65 CE

LK858575

LK858575-T

外形尺寸、安装孔及孔位图

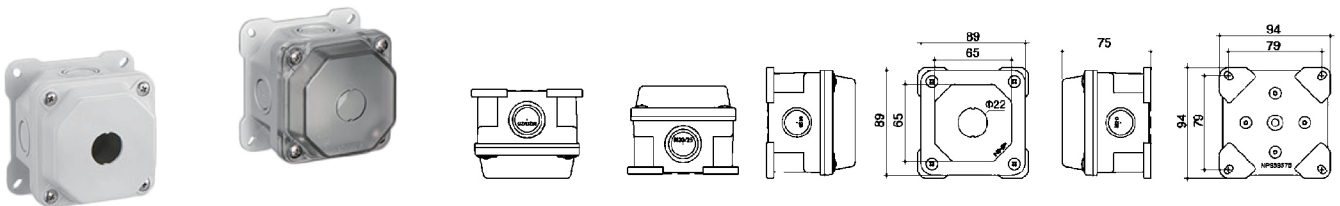

LK851475

LK851475-T

外形尺寸、安装孔及孔位图

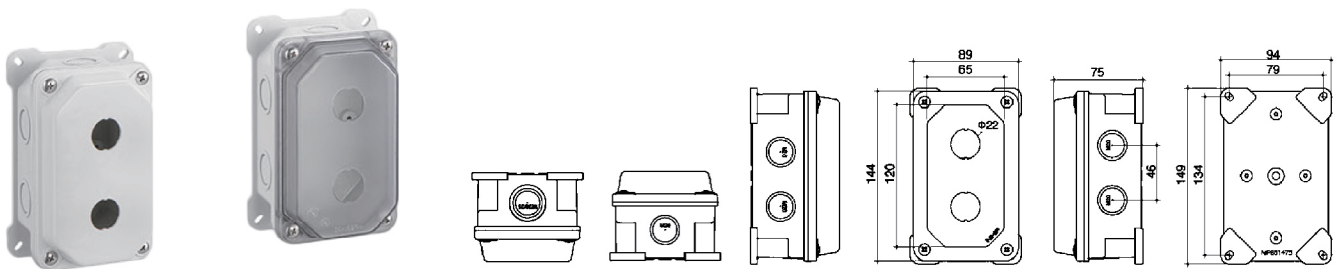

LK111180

LK111180-T

外形尺寸、安装孔及孔位图

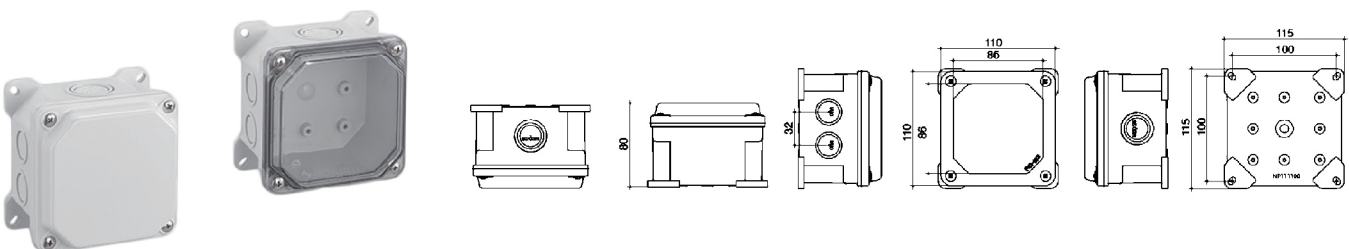

LK131390

LK131390-T

外形尺寸、安装孔及孔位图

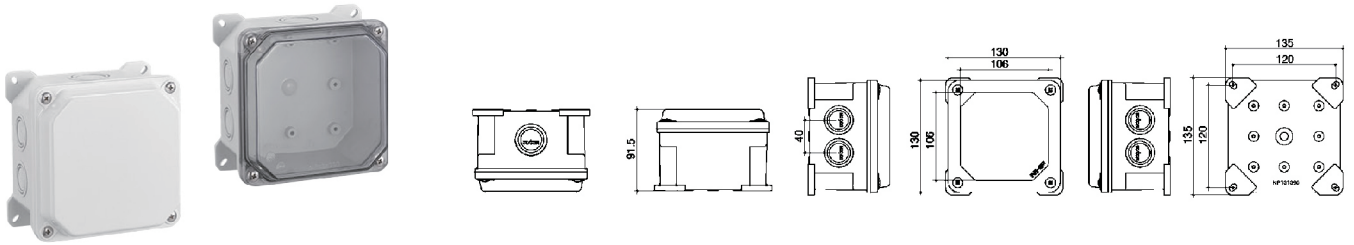

LK131890

LK131890-T

外形尺寸、安装孔及孔位图

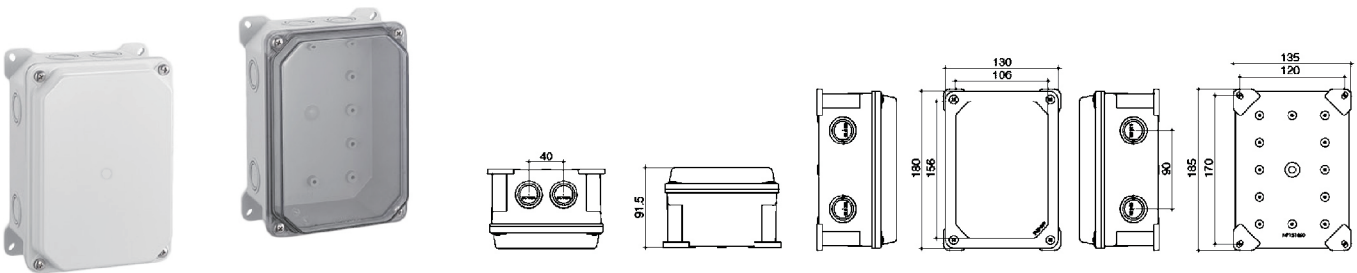

LK161690

LK161690-T

外形尺寸、安装孔及孔位图

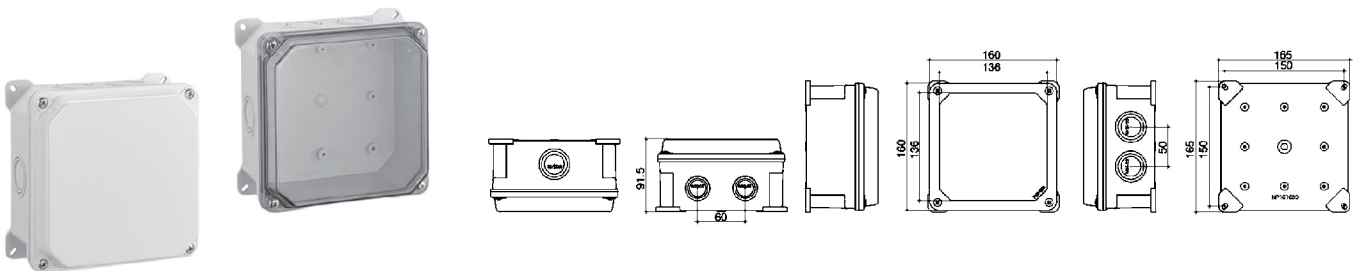

LK162111

LK162111-T

外形尺寸、安装孔及孔位图

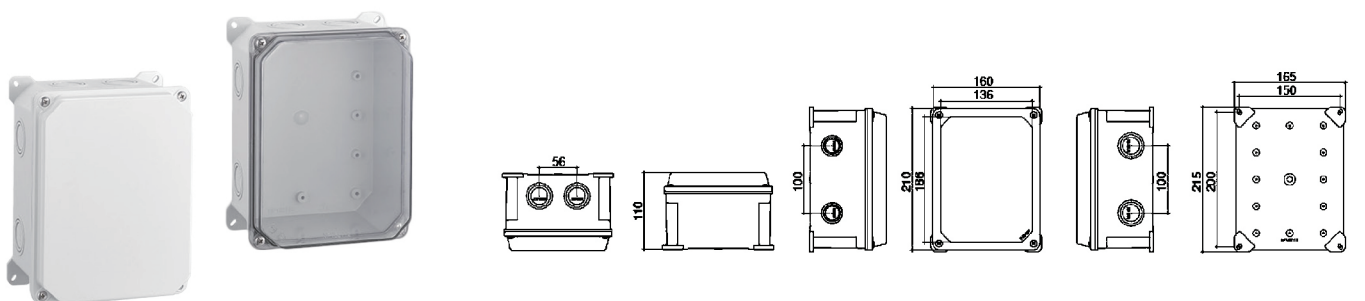

LK162112

LK162112-T

外形尺寸、安装孔及孔位图

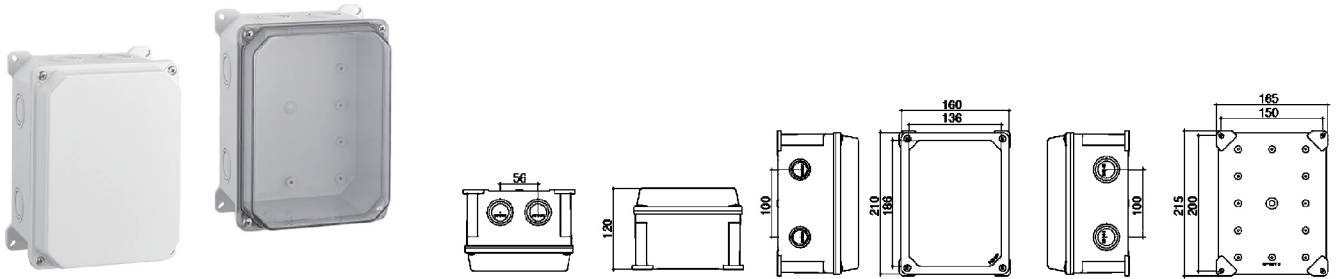

LK182511

LK182511-T

外形尺寸、安装孔及孔位图

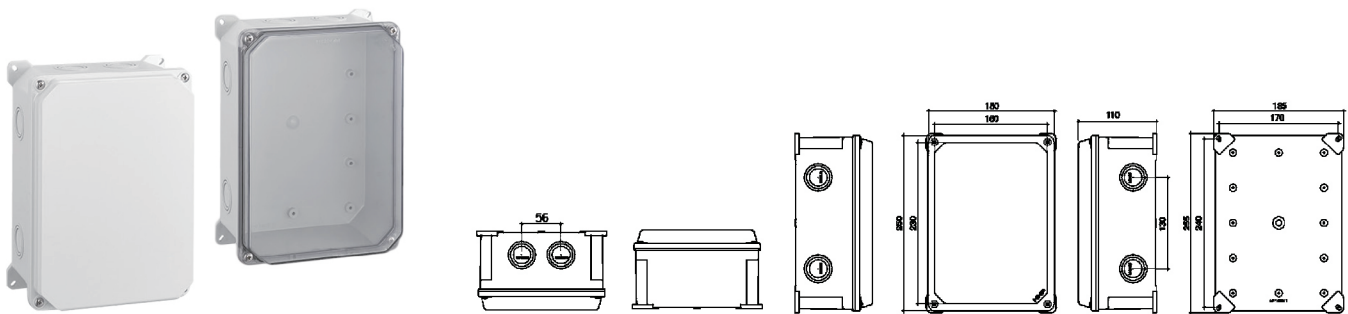

LK182512

LK182512-T

外形尺寸、安装孔及孔位图

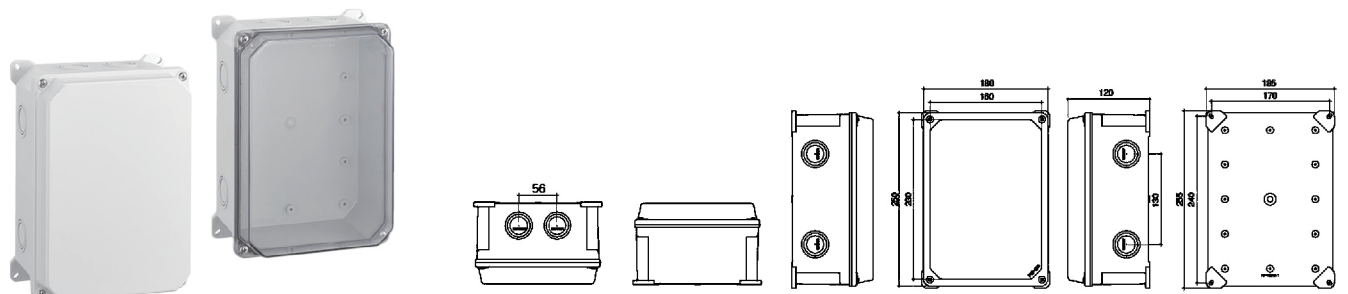

LK202011

LK202011-T

外形尺寸、安装孔及孔位图

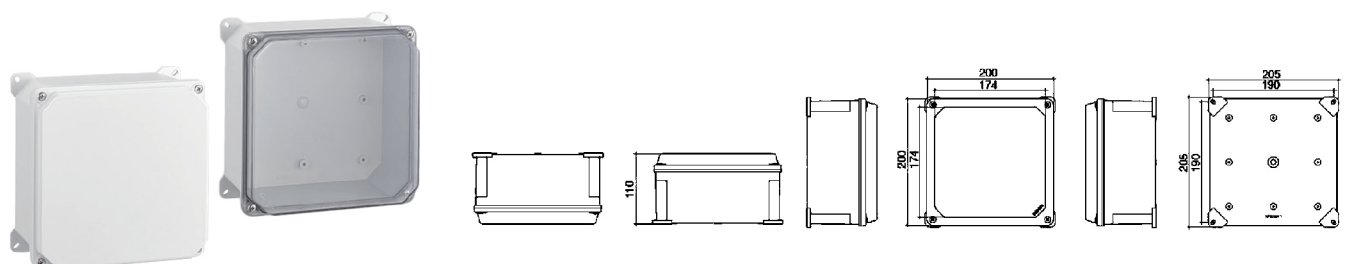

IP65 CE

LK202012

LK202012-T

外形尺寸、安装孔及孔位图

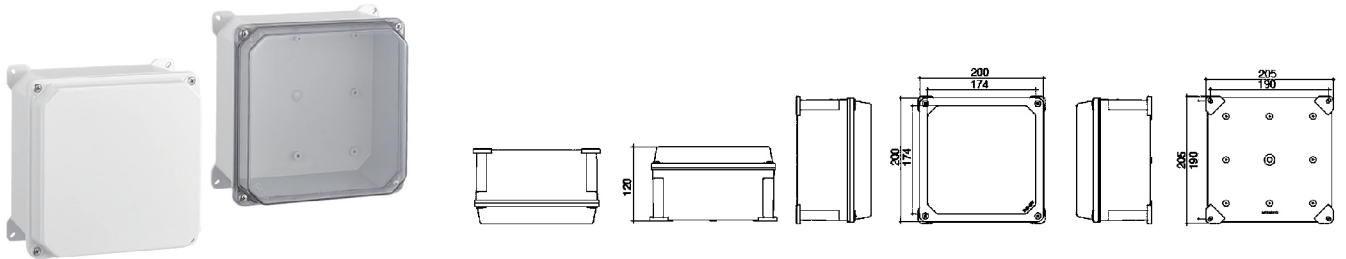

LK212911

LK212911-T

外形尺寸、安装孔及孔位图

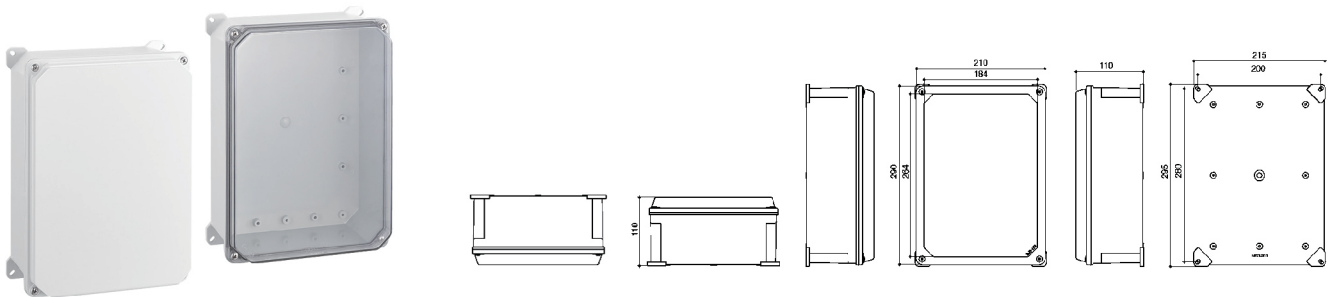

LK212912

LK212912-T

外形尺寸、安装孔及孔位图

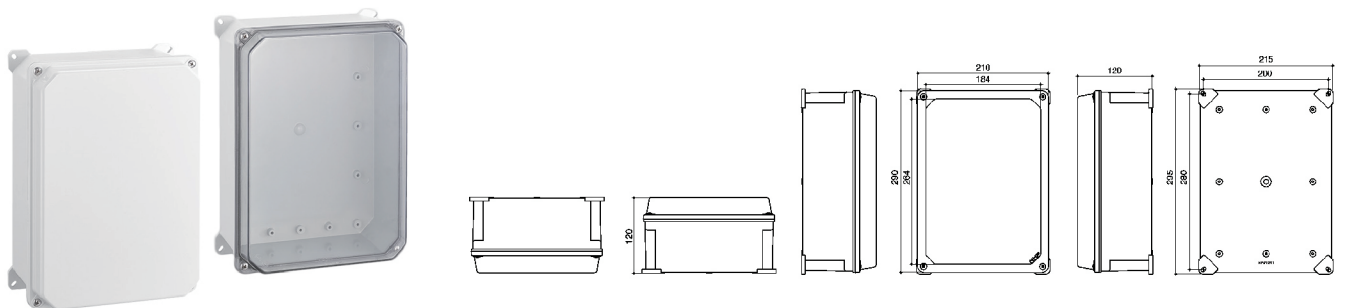

断路器

IP65 CE

- 三极负载隔离开关
- 带中性点和接地点
- 4 个 M16 接线孔
- 8 个 M20/M25 接线孔

- 聚碳酸酯箱体
- 防护等级 IP65
- 可加装插接极
- 可加装 M 型辅助触点模块

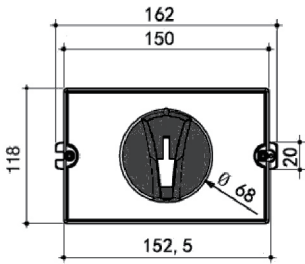

16-40A

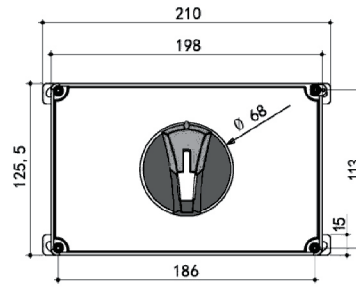
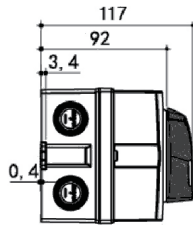

63-100A

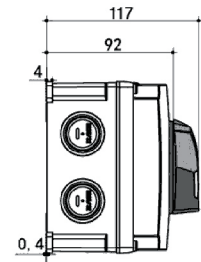

	容量	极	手柄颜色	箱体颜色	订货号
空盒子	16...40	3	黑色	灰色	LK59305
	16...40	3	红色	黄色	LK59405
	63...80	3	黑色	灰色	LK59309
	63...80	3	红色	黄色	LK59409
带开关盒	16	3	黑色	灰色	LK53300
	16	3	红色	黄色	LK53400
	20	3	黑色	灰色	LK53301
	20	3	红色	黄色	LK53401
	25	3	黑色	灰色	LK53302
	25	3	红色	黄色	LK53402
	32	3	黑色	灰色	LK53303
	32	3	红色	黄色	LK53403
	40	3	黑色	灰色	LK53304
	40	3	红色	黄色	LK53404
	63	3	黑色	灰色	LK53306
	63	3	红色	黄色	LK53406
	80	3	黑色	灰色	LK53308
	80	3	红色	黄色	LK53408
	100	3	黑色	灰色	LK53309
	100	3	红色	黄色	LK53409

STK系列透明连接保护窗罩

指示器功能
Indicator function

格栅板可分离设计
Grid-plate Separable design

不锈钢螺丝，可用手拧紧
Stainless steel screw
It can be tightened by hand

UL94 V-0 级
UL94V0 level

一体式密封圈 IP67防水等级
Integrated sealing ring
IP67 waterproof rating

导向环结构提高安装效率
Guide ring structure
Improve installation efficiency

外周凸起防挫伤
Peripheral bulge
anti-bruising

一体式密封圈 IP67防水等级
Integrated sealing ring
IP67 waterproof rating



STK-02A

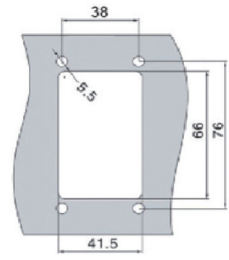
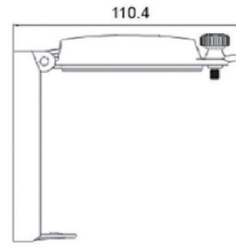
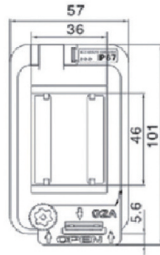

STK-03A

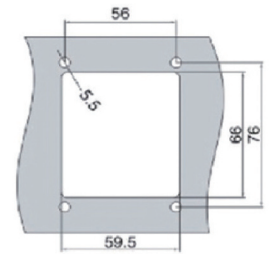
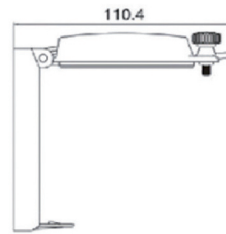
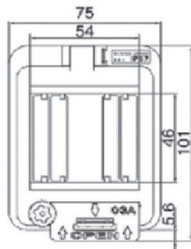

STK-04A

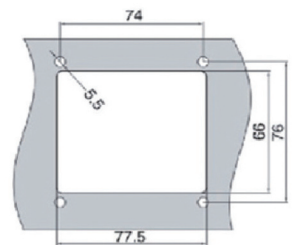
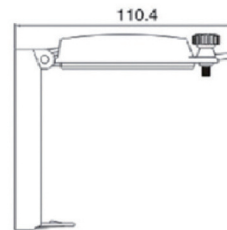
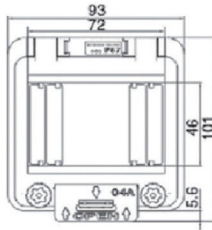

STK-06A

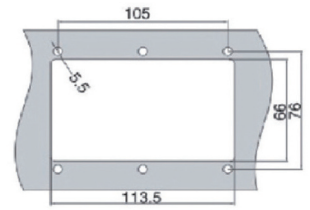
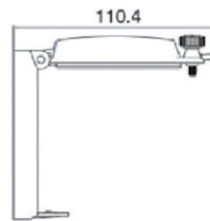
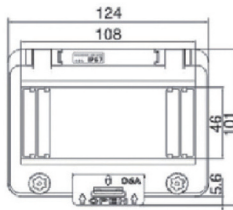

STK-08A

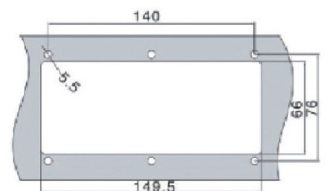
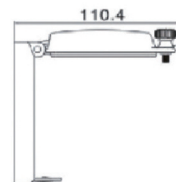
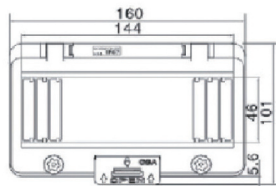

STK-10A

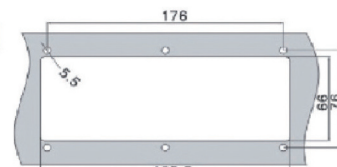
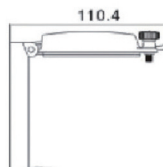
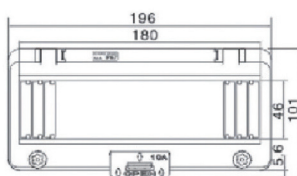

STK-12A

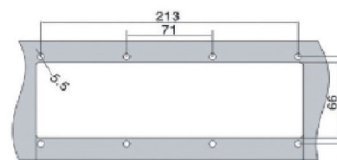
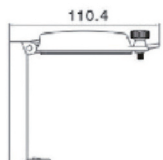
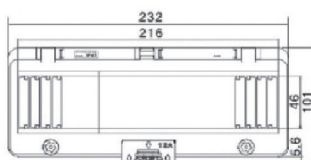

STK-13A

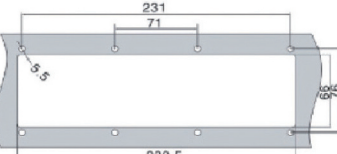
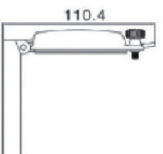
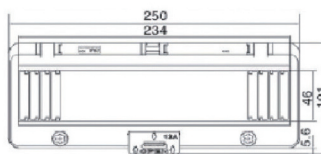

STK-16A

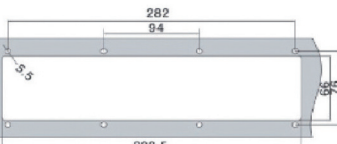
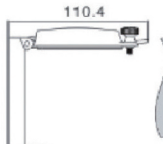
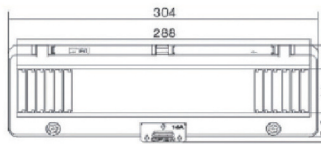

STK-18A

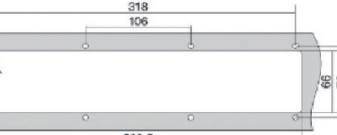
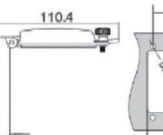
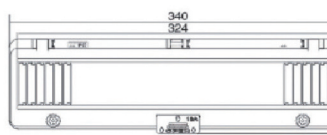

STK-K05A

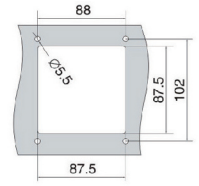
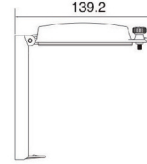
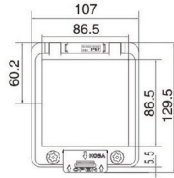

STK-K100A

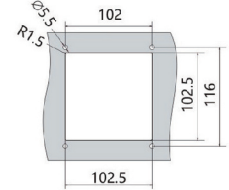
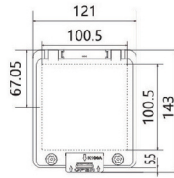

STK-K144A

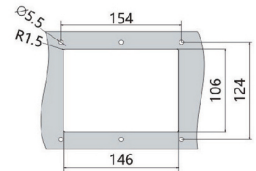
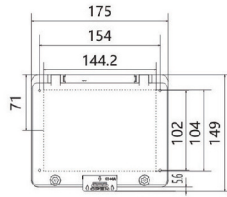

STK-K123A

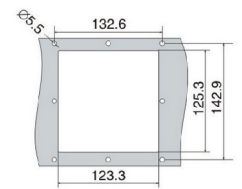
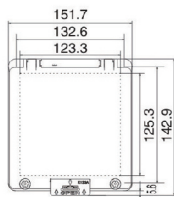

STK-K123S

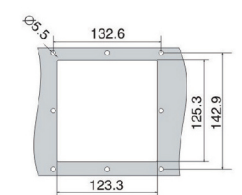
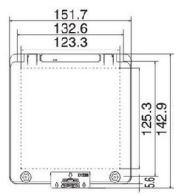

STK-K150A

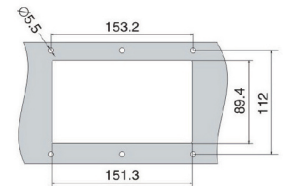
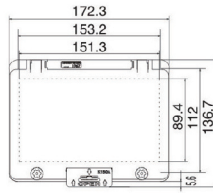

STK-K173S

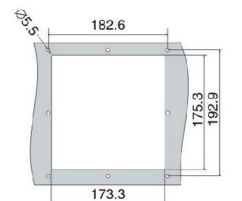
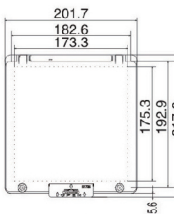

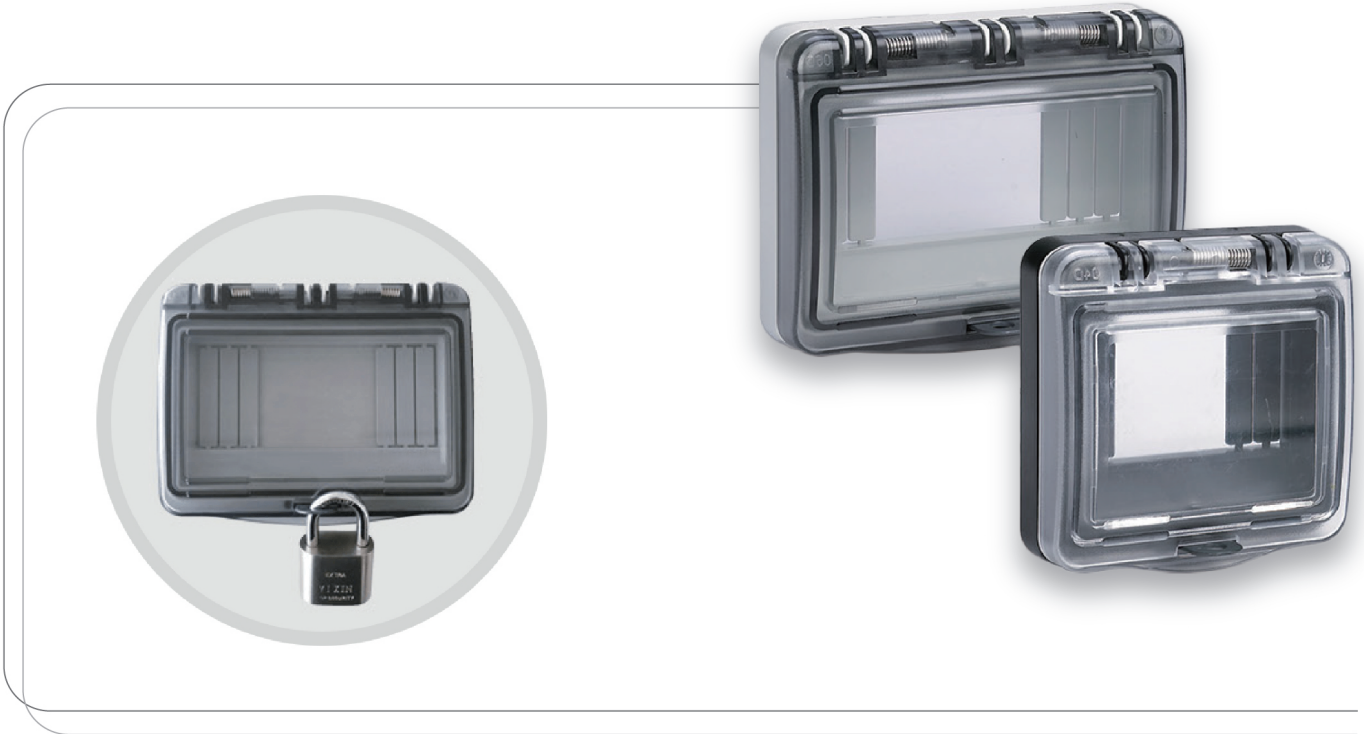

LK4-04D

LK4-04D产品外形尺寸、安装孔位图

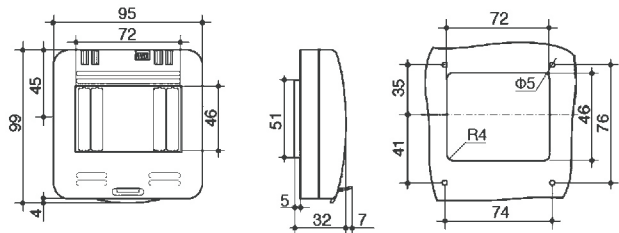

LK4-06D

LK4-06D产品外形尺寸、安装孔位图

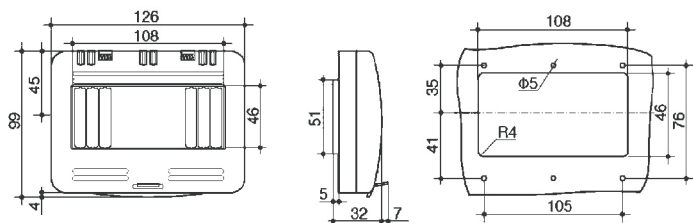

LK4-08D

LK4-08D产品外形尺寸、安装孔位图

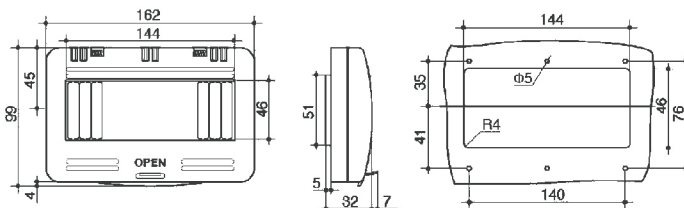

LK4-10D

LK4-10D产品外形尺寸、安装孔位图

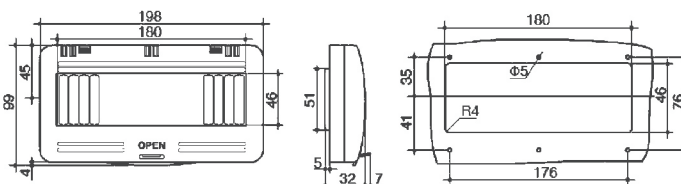

LK4-12D

LK4-12D产品外形尺寸、安装孔位图

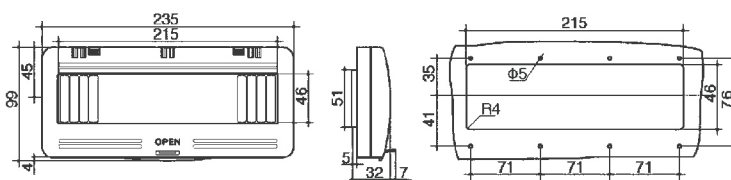

LK4-14D

LK4-14D产品外形尺寸、安装孔位图

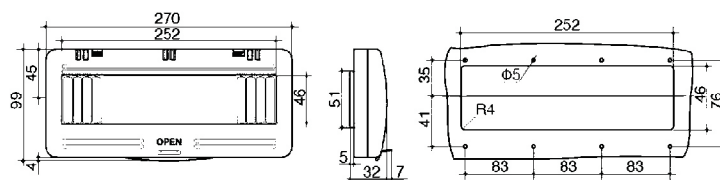

适用于防水、防尘、防腐等特殊场合
执行标准:IEC60529、IP65、EN60309



LK04-200

LK04-200产品外形尺寸、安装孔位图

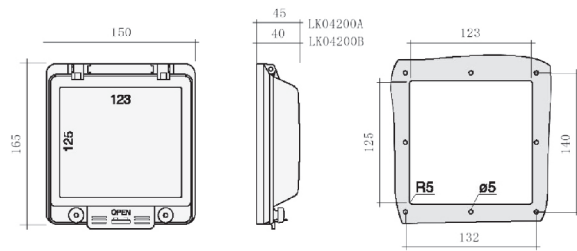

LK04-400

LK04-400产品外形尺寸、安装孔位图

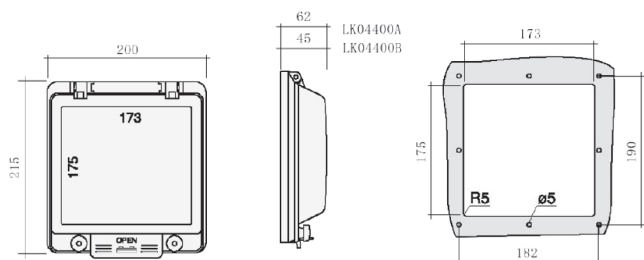



LK4-26B产品外形尺寸、安装孔位图

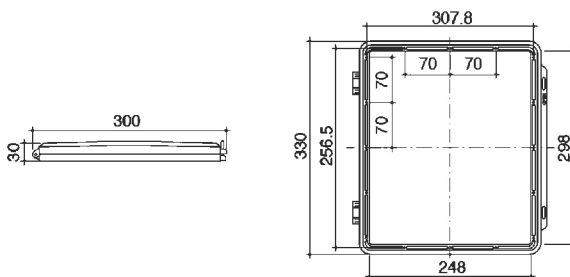

LK4-36B产品外形尺寸、安装孔位图

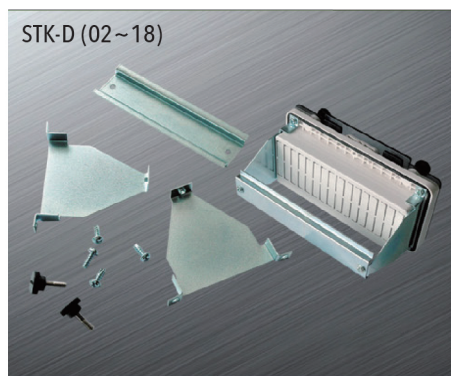
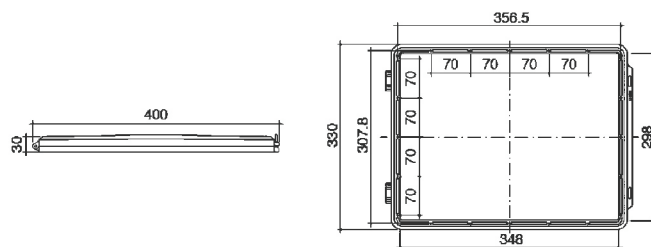

STK 配套支架和导轨套件

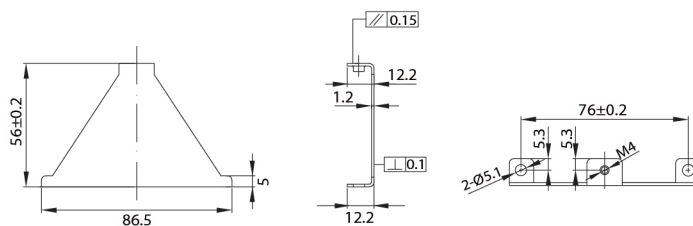

LK0908配电箱透明窗

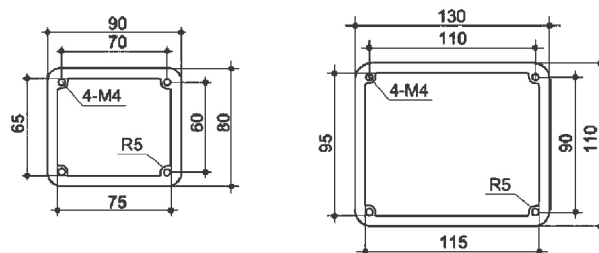



触摸屏保护罩7寸

开孔尺寸	适合品牌	触摸屏型号
192x138mm	SIEMENS OMRON MITSUBISHI KUNLUNTONGTAI WEILUN SAMKOON YOUKONG INOVANCE KINCO FLEXEM HOLLYSYS XINJE	SMART700 IE V3 NB7W-TW11B NB7Q-TW00B/01B GS2107-WTBD TPC7062KD(HL/HN TK6071 IQ/IP TK8071 IE/IP MT6071 IE/IP MT8071 IP CMT3072 SK-070BE MM-30MR/40MR IT6070T IT6070E ET070 FE6070 HT8720T TG765
197x143mm	SIEMENS DELTA	YP177A KTP600 DOP-B07S410/07S411/07S415/07E411
211x145mm	HOLLYSYS SAMKOON	HT8700T HT8700TE SK-070AE/BC/AS
215x152mm	KUNLUNTONGTAI	TPC7062TD/KT TPC7062TX/KXTI



触摸屏保护罩10寸

开孔尺寸	适合品牌	触摸屏型号
261x181mm	KUNLUNTONGTAI OMRON COOLMAY SOSU FLEXEM YOUKONG XINJE	TPC1061TD/TX/TT NA5-9W001B NA5-9W001S EX3G-100HA/HB SS-150WD FM6100C MM1001-52MR THA62 TGA63 TGC65



触摸屏保护罩10.5寸

开孔尺寸	适合品牌	触摸屏型号
260x202mm	SIEMENS OMRON MITSUBISHI KUNLUNTONGTAI WEILUN	SMART1000 IE 6MART1000 IE V3 SMART1000IE 6AV6648-OCE11 NB10Q-TWOOB NB10Q-TWO1B GS2110-WTBD TPC1061HNTPC1162HN MT8103IE MT61011Q MT6013IP MT8101IE MT8102IP MT8012IE CMT3103 EMT3105P
255x202mm	YUANJUN	YJ150DZ
262x192mm	DELTA	DOP-B10S4LLDOP-B10S615
150x192mm	WEILUN	CMT3090 CMT-IV5 CMT-IPC10
260x205mm	RONGGE	RG-XSQ010



触摸屏保护罩12寸

开孔尺寸	适合品牌	触摸屏型号
310x220mm	SIEMENS	TP1200 KTP1200



LINKWELL创新大平板玻璃信息箱，为每一个细节注入灵魂，是艺术家致力于再现纯粹质感结合尖端科技的热情之作，从自然中汲取灵感，让每一双眼睛都定格，享受精彩多元的温馨生活。



配电箱为钢化玻璃盖金属箱，主要用于：

- 建筑配电系统的电气安装、配套及改造。
- 安装方式为金属盒与塑料盖板组合，特别适用于建筑及装修工程中配电箱的隐蔽安装。
- 时尚的外观设计，适用于彰显现代生活品味的高端住宅、酒店及办公楼。
- 符合标准的产品均已获得3C认证，符合GB17466.1和GB17466.24标准。

	行	规格	整体尺寸	底盒尺寸
			mm	mm
LYB2-16	1	16	370x270x107	340x250x90
LYB2-20	1	20	442x270x107	412x250x90
LYB2-24	2	24	298x470x107	268x450x90
LYB2-32	2	32	370x470x107	340x450x90
LYB2-40	2	40	442x470x107	412x450x90
LYB2-48	3	48	370x670x107	340x650x90
LYB2-60	4	60	442x670x107	412x650x90



LINKWELL

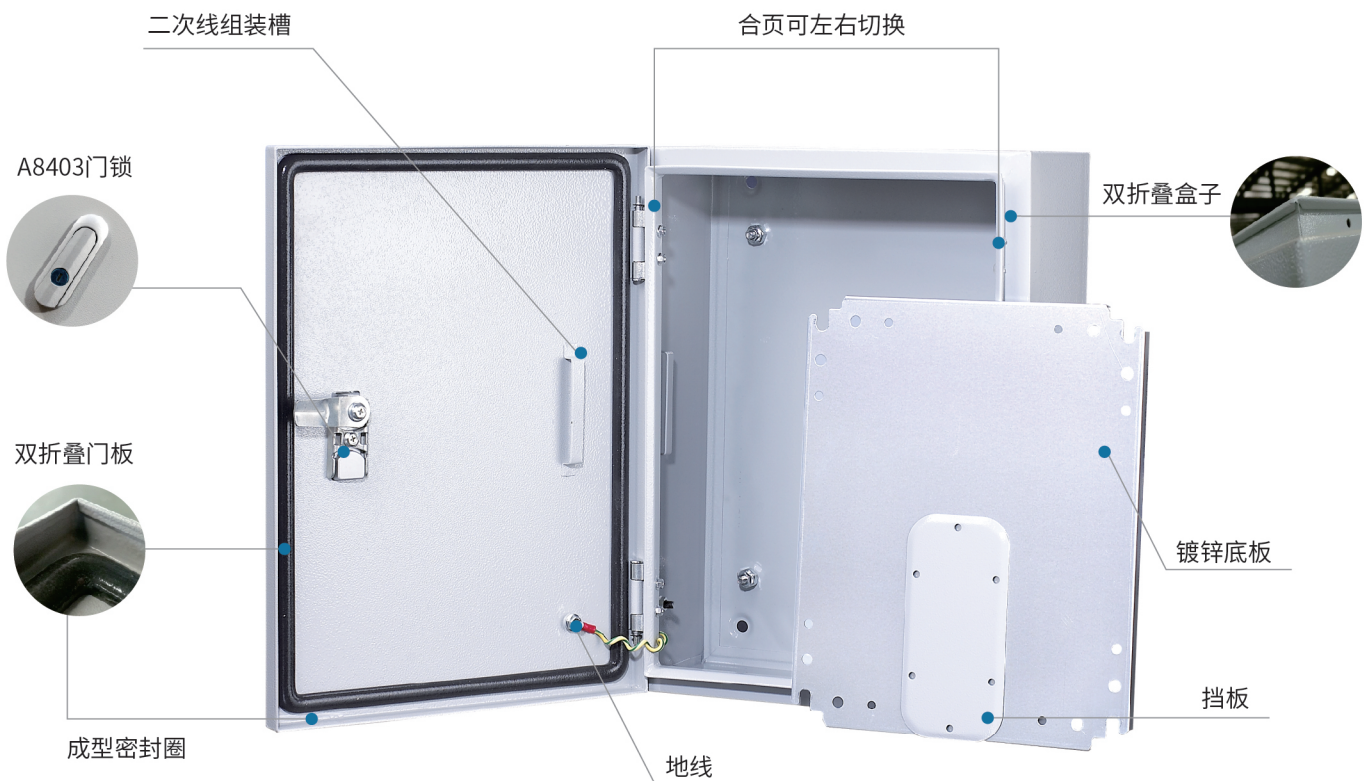

JXF系列控制箱



	整体尺寸			类型/规格			
	W (mm)	H (mm)	D (mm)	A-型 箱子/安装板/门 1.4/1.5/1.7 (mm)	B-型 箱子/安装板/门 1.2/1.2/1.4 (mm)	C-型 箱子/安装板/门 1.0/1.0/1.2 (mm)	D-型 箱子/安装板/门 1.0/0.8/1.0 (mm)
JXF-300400/155	300	400	155	•	•	•	•
JXF-400500/155	400	500	155	•	•	•	•
JXF-400600/155	400	600	155	•	•	•	•
JXF-500600/155	500	600	155	•	•	•	•
JXF-500700/155	500	700	155	•	•	•	•
JXF-600700/155	600	700	155	•	•	•	•
JXF-600800/155	600	800	155	•	•	•	•
JXF-300400/210	300	400	210	•	•	•	•
JXF-400500/210	400	500	210	•	•	•	•
JXF-400600/210	400	600	210	•	•	•	•
JXF-500600/210	500	600	210	•	•	•	•
JXF-500700/210	500	700	210	•	•	•	•
JXF-600700/210	600	700	210	•	•	•	•
JXF-600800/210	600	800	210	•	•	•	•
JXF-700900/210	700	900	210	•	•	•	•
JXF-6001000/210	600	1000	210	•	•	•	•
JXF-8001000/210	800	1000	210	•	•	•	•
JXF-300400/250	300	400	250	•	•	•	•
JXF-400500/250	400	500	250	•	•	•	•
JXF-400600/250	400	600	250	•	•	•	•
JXF-500600/250	500	600	250	•	•	•	•
JXF-500700/250	500	700	250	•	•	•	•
JXF-600700/250	600	700	250	•	•	•	•
JXF-600800/250	600	800	250	•	•	•	•
JXF-700900/250	700	900	250	•	•	•	•
JXF-6001000/250	600	1000	250	•	•	•	•
JXF-8001000/250	800	1000	250	•	•	•	•
JXF-500600/300	500	600	300	•	•	•	•
JXF-500700/300	500	700	300	•	•	•	•
JXF-600700/300	600	700	300	•	•	•	•
JXF-600800/300	600	800	300	•	•	•	•
JXF-700900/300	700	900	300	•	•	•	•
JXF-6001000/300	600	1000	300	•	•	•	•
JXF-8001000/300	800	1000	300	•	•	•	•

PB系列横线式防水盒

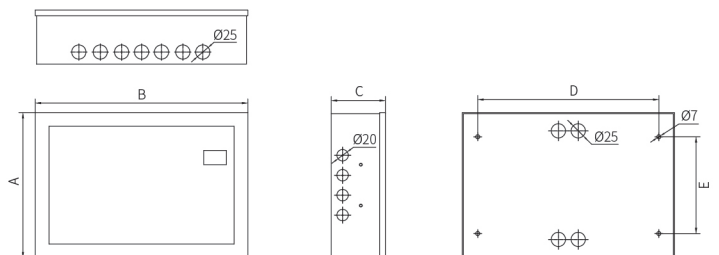

	A (mm)	B (mm)	C (mm)	D (mm)	E (mm)
PB-16	270	440	110	384	185
PB-32	420	440	110	384	335
PB-48	570	440	110	384	485
PB-64	720	440	110	384	635
PB-80	870	440	110	384	785
PB-96	1020	440	110	384	935



LK171275-10/15P

尺寸: 175x125x75mm

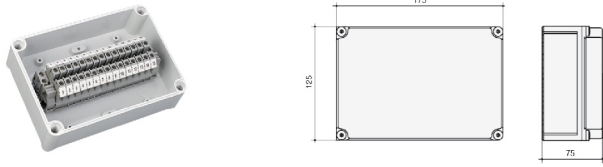

LK201510-15/20P

尺寸: 200x150x100mm

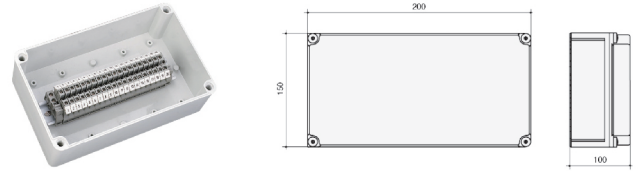

LK808052

尺寸: 80x80x52mm

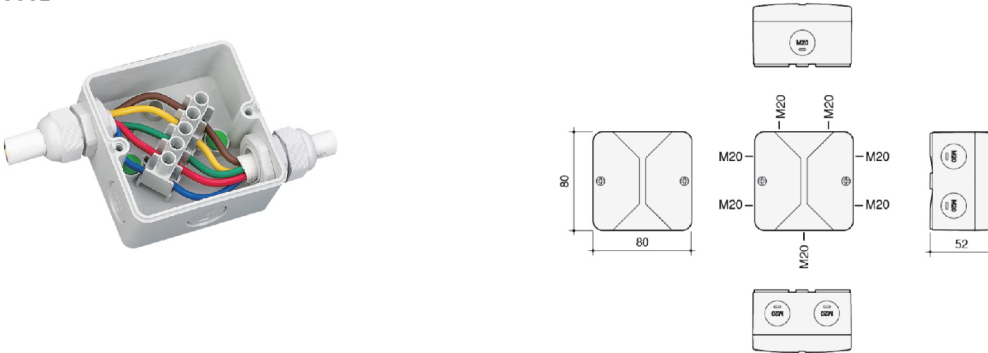

LK939355

尺寸: 93x93x55mm

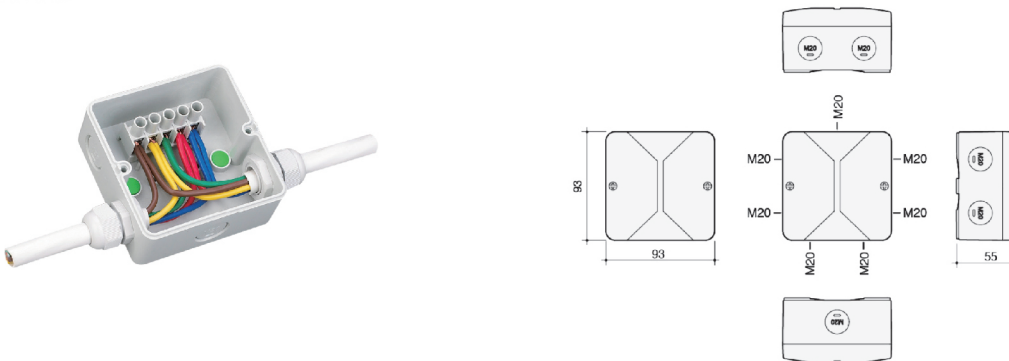

LK111167

尺寸: 110x110x67mm

